

A

B

C

D

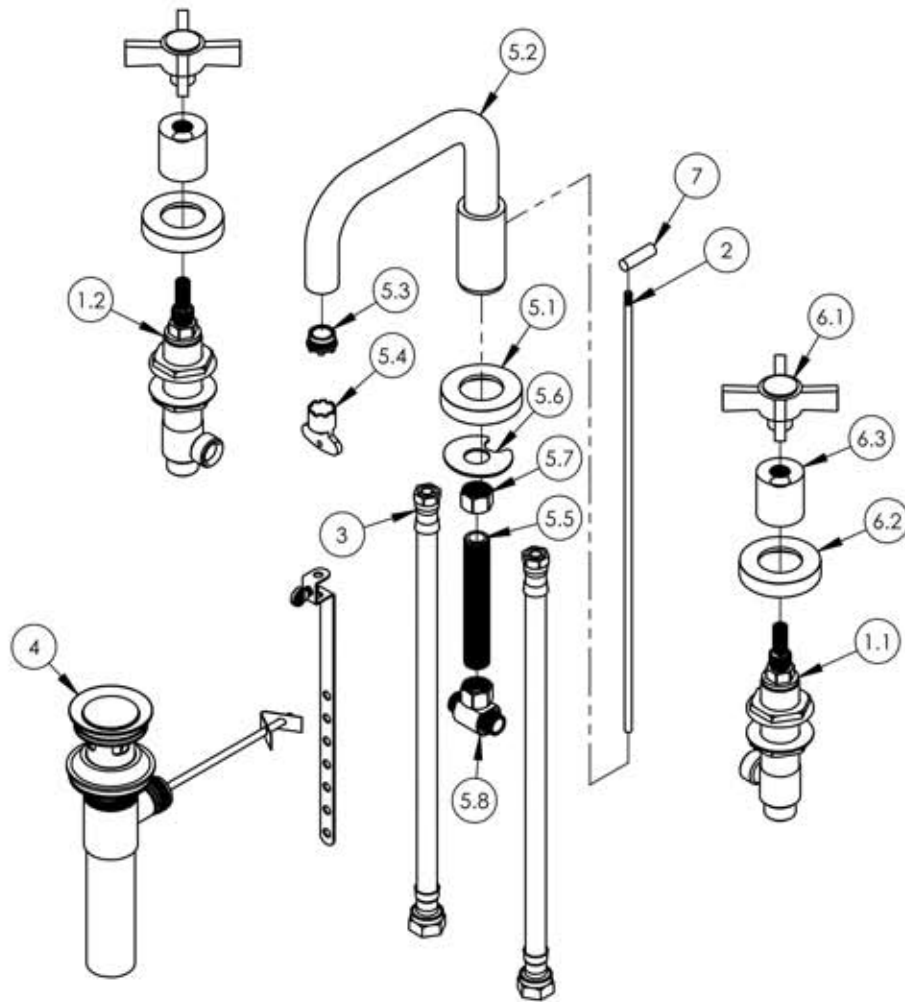

ITEM NO.	PART NUMBER	DESCRIPTION	QTY.
1	1-600	WIDESPREAD HOT AND COLD VALVES W/PLASTIC NUTS	1
1.1	1-109	WIDESPREAD VALVE COLD LAV 16PT	1
1.2	1-110	WIDESPREAD VALVE HOT LAV 16PT	1
2	10719/00	POP-UP ROD, 10-24, 14" LONG	1
3	10982	HOSE, 3/8" COMP. X 1/2" NPSM - 12'L	2
4	3-046/00	POP-UP DRAIN ASSEMBLY (2-101, 2-102)	1
5	3-181/00	WIDESPREAD FAUCET FLAT SPOUT, BASIC	1
5.1	P02035_2/00	ESCUTCHEON, CONTEMPORARY	1
5.2	2-166	SUB ASSY. FLAT SPOUT, BASIC	1
5.3	11428	AERATOR CACHE TINY JUNIOR 1.2GPM 43.2260.450 PINK	1
5.4	P05022	AERATOR, BASIC KEY, PLASTIC GREEN	1
5.5	10745	THREAD ALL, 3/8"-18 NPSL	1
5.6	92174	WASHER MOUNT WIDESPREAD (3/8")	1
5.7	10746	NUT, 3/8"-18 NPSL	1
5.8	1-112	TEE VALVE, 3/8" NPSM X 3/8" COMPRESSION	1
6	3-443/00	ASSY. BLADE CROSS HANDLE, BASIC	2
6.1	3-440/00	ASSY. BLADE HANDLE, BASIC SERIES	1
6.2	P02035_2/00	ESCUTCHEON, CONTEMPORARY	1
6.3	P02035_1	HUB ESCUTCHEON, CONTEMPORARY TOP	1
7	P04019/00	POP-UP, BASIC, W/ 10-24 THREAD	1

E

ALL	B	UPDATED WITH SUB ASSEMBLIES	2/8/2016	GRE
ZONE	REV.	DESCRIPTION	DATE	
REVISIONS				

1261 LOGAN AVENUE
COSTA MESA, CALIFORNIA 92626
PHONE: 714.361.4800
FAX: 714.617.3120

PHYLORICH®

Defining Luxury Since 1959

PROPRIETARY AND CONFIDENTIAL

THE INFORMATION CONTAINED IN THIS DRAWING IS THE SOLE PROPERTY OF RISS MANUFACTURING. ANY REPRODUCTION IN PART OR AS A WHOLE WITHOUT THE WRITTEN PERMISSION OF RISS MANUFACTURING IS PROHIBITED.

-	-	INTERPRET GEOMETRIC DIMENSIONING & TOLERANCING IN ACCORDANCE WITH ASME Y14.5-2009 & ASME Y14.41-2003 STANDARDS, UNLESS OTHERWISE SPECIFIED. DIMENSIONS ARE IN INCHES. TOLERANCES ARE:		
NEXT ASSY	USED ON	FRACTIONS ±1/64"	DECIMALS X.X: ±.1 X.XX: ±.01 X.XXX: ±.005	ANGULAR ±.5°
APPLICATION		MATERIAL	NAME	DATE
FINISH		DRAWN	10/14/2015	
DO NOT SCALE DRAWING		CHECKED	GRE	

WIDESPREAD FAUCET, BLADE CROSS HANDLES, FLAT SPOUT, BASIC SERIES.

SIZE	ASM/PRT NO.	REV
A	D139/00	B

SCALE: 1:5 WEIGHT: lbs. SHEET 1 OF 2

5

4

3

2

1